

Early Hearing Detection & Intervention



DENVER, COLORADO

ehdimeeting.org

Hyatt Regency Denver at the Colorado Convention Center
March 18-20, 2018

*Hackensack Meridian Health has one of the highest rates of follow-up (100%)
in the New Jersey Early Hearing Detection Program.*

Striving for 100% Follow-up Rate

LUNCH & LEARN SEMINAR

Capitol 4 Ballroom | March 20, 2018 | 12:00 - 1:45PM

— Register at Booth 25 to Attend —

GUEST SPEAKERS

Dr. Kenneth Bodkin, Au.D., PASC

Manager of Audiology, Hackensack University Medical Center,
Hackensack Meridian Health
Adjunct Professor, Montclair State University
COO, Hackensack Audiology & Hearing Aid Associates

Dr. Maryrose McInerney, Ph.D., CCC-A

Faculty, Audiology Doctoral Program Communication Science and
Disorders, Montclair State University
Senior Audiologist, Hackensack University Medical Center,
Hackensack Meridian Health
CEO, Hackensack Audiology & Hearing Aid Associates

LEARN ABOUT

- Important indicators of success
- Impact of audiologists in hearing screening
- Keys to evidence-based follow-up practice
- Tips on timing of hearing screening for different populations
- Best practice for screening and diagnostics
- Benefits of centralized scheduling
- Follow-up of late onset and progressive hearing loss: Important indicators for follow-up

References

Suggestions for risk monitoring for delayed-onset hearing loss
Follow-up of late onset and progressive hearing loss: Important indicators



**AUTOMATED ABR
SCREENING**



**DIAGNOSTIC ABR
FOLLOW-UP**



1 System

3 Innovations

6 Good Reasons

DOWNLOAD OUR FREE APP



Download the **Attendify app**, Available on the App Store and Google Play

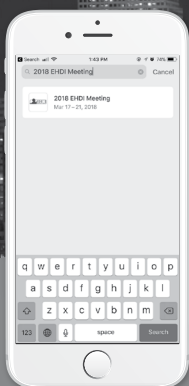

Search for **2018 EHDI Meeting** to gain access to: Personal Schedule, Activity Stream, CEU Forms, Maps, Family Info, Student Info, Polls, Up-to-date Info, AND Much More!



Table of Contents

Acknowledgements.....	2
Welcome	3
Continuing Education Units	4
Local Information.....	5
Antonia Brancia Maxon Award for EHDI Excellence.....	7
Family Leadership Award for EHDI Excellence	8
Plenary Session Abstracts & Speaker Bios	10-12
Exhibit Hall Layout	14
Exhibit Booth Locations.....	15
List of Exhibitors	16-17
Sponsors.....	20
Hotel Map	21
Agenda At-A-Glance	Back Outside Cover
Detailed Agenda	See Pull-Out Insert

Photos in this program are courtesy of:

Advanced Bionics; Centers for Disease Control and Prevention; Cochlear Americas; Florida School for the Deaf & the Blind; Gallaudet University; John Tracy Clinic; MED-EL; The National Center for Hearing Assessment and Management; Oticon A/S; Phonak; Siemens Hearing Instruments; Sound Beginnings / Utah State University; Two Little Hands Productions

Although **hearing loss** happens in the ears, the real effect is in **the brain**



Oticon | Sensei

Oticon BrainHearing™ technology: Giving the child's developing brain what it needs.

Sound plays an important role not only in cognitive development, but also speech and language development, learning, social development, and many other areas.

At Oticon, we know that sensorineural hearing loss can disrupt the normal course of cognitive development and organization of the brain. Our goal is to develop hearing solutions that provide the brain with the very best auditory information, so that the child has the best possible opportunity to get the most out of speech.

Join Oticon's mission to ensure a better future for every child with hearing loss.



www.oticon.com

oticon
PEDIATRICS

ACKNOWLEDGMENTS

The meeting organizers recognize and thank the members of the 2018 EHDI Annual Meeting Planning Committee for their hard work and dedication in creating an engaging and productive conference.

EHDI ANNUAL MEETING ORGANIZERS

American Academy of Pediatrics (AAP) | Hands & Voices | National Center for Hearing Assessment and Management (NCHAM) at Utah State University | U.S. Department of Health and Human Services: Health Resources and Services Administration (HRSA)/Maternal and Child Health Bureau (MCHB)

PLANNING COMMITTEE MEMBERS

Zainab Alkebsi zainab.alkebsi@nad.org	National Association of the Deaf (NAD)	Yiesell Rayon yiesell@handsandvoices.org	Hands & Voices
Sarah Ammerman ammerman@uthscsa.edu	University of Texas Health Science Center	Ashley Renslow arenslow@csdb.org	Colorado School for the Deaf and the Blind
Brenda Balch bkbalch@sbcglobal.net	American Academy of Pediatrics (AAP)	Sandi Ring sring@aap.org	American Academy of Pediatrics (AAP)
Sandra Battiste SBattiste@hrsa.gov	Health Resources and Services Administration, Maternal and Child Health Bureau (HRSA/MCHB)	Tony Ronco t_ronco@hotmail.com	Hands & Voices
Treeby Brown TBrown2@hrsa.gov	Health Resources and Services Administration, Maternal and Child Health Bureau (HRSA/MCHB)	Hanna Sawher hanna.sebring@wisc.edu	University of Wisconsin-Madison
Kirsten Coverstone Kirsten.Coverstone@state.mn.us	Minnesota EHDI Program	Lisa Schimmenti schimmenti.lisa@mayo.edu	American Academy of Pediatrics (AAP)
Pam Dawson pdawson@hear-me-now.org	Hear Me Now	Sadie Silcott ssilcott@hrsa.gov	Health Resources and Services Administration, Maternal and Child Health Bureau (HRSA/MCHB)
Janet DesGeorges janet@handsandvoices.org	Hands & Voices	Vickie Thomson vickie.thomson@ucdenver.edu	Colorado EHDI Program
Michelle Esquivel MEsquivel@aap.org	American Academy of Pediatrics (AAP)	Alyson Ward Alyson.Ward@usu.edu	National Center for Hearing Assessment and Management (NCHAM)
Jeannene Evenstad jeannene@handsandvoices.org	Colorado Hands & Voices	Karl White Karl.White@usu.edu	National Center for Hearing Assessment and Management (NCHAM)
Marcia Fort marcia.fort@dhhs.nc.gov	North Carolina EHDI Coordinator/DSHPHWA	STAFF	
Gayla Guignard gguignard@agbell.org	AG Bell		
Linda Hazard Linda.Hazard@partner.vermont.gov	Vermont EHDI Program	Casey Judd, Conference Direct	
Thomas Horejes thomas.horejes@gallaudet.edu	Gallaudet University	Mandy McClellan, Meeting Coordinator, NCHAM	
Vicki Hunting vicki@handsandvoices.org	Hands & Voices	Joy Brisighella, Utah State University Conference Management Services	
Casey Judd casey.judd@conferencedirect.com	Conference Direct	SPECIAL THANKS	
Michelle Koplitz mkoplitz@hrsa.gov	Health Resources and Services Administration, Maternal and Child Health Bureau (HRSA/MCHB)	We would also like to thank the Abstract Review Committee Members for lending time and expertise, Room Moderators for helping the meeting run smoothly, and all of the contractors whose behind the scenes magic allows us to enjoy and get the most out of the Meeting.	
Christine Liao cliao@aucd.org	Association of University Centers on Disabilities (AUCD)	CONFERENCE MANAGEMENT SERVICES PROVIDED BY	
Mandy McClellan mandy.mcclellan@usu.edu	National Center for Hearing Assessment and Management (NCHAM)	Casey Judd- Conference Direct	
Karin Neidt karin.neidt@doh.wa.gov	Washington State EHDI Program/DSHPHWA	421 East Eagle Way Preston, Idaho 83263 435-213-9454 www.conferencedirect.com	
		Utah State University Conference Management Services	
		5005 Old Main Hill Logan, Utah 84322-5005 435-797-9270 www.conference.usu.edu	

Welcome to Denver, Colorado and the 2018 National EHDl Meeting!

In its 17th year, the EHDl Meeting has built a strong reputation for bringing together a wide variety of attendees including those who: work in state Early Hearing Detection and Intervention programs; assist in EHDl efforts on the federal level; provide screening, diagnostic and early intervention support at the state/ local level to young children with hearing loss and their families; champion Medical Home activities within each state; are parents of children with hearing loss; or are deaf or hard-of-hearing adults who are helping to expand opportunities for young children with hearing loss. EHDl Meeting participants will range from state and local programs to the federal level and from academics to families.

GOAL OF THE EHDl ANNUAL MEETING

The goal of this meeting is to enhance the implementation of comprehensive state-based Early Hearing Detection and Intervention (EHDl) programs.

LEARNING OBJECTIVES FOR PARTICIPANTS

- Identify and promote knowledge and awareness of successful strategies for implementing comprehensive state-based EHDl programs that include screening, audiologic diagnostic evaluation, early intervention, medical home, reporting, tracking, surveillance, loss to follow-up issues, data integration, and other related surveillance components.
- Interpret and describe current research and research methods related to EHDl.
- Examine cultural competence of providers and assess their ability to work with children who are deaf or hard of hearing, their families, and communities.
- Discuss the importance of enhancing and creating new and ongoing working relationships among federal agencies, non-profit organizations, state health departments and educational agencies, advocacy groups, families, and professionals.

PRINCIPLES OF PARTICIPATION

The right to participate in the EHDl Annual Meeting is fundamental to ensuring open dialogue between all EHDl stakeholders. The Meeting Organizers encourage respectful dialogue as a key element of participation among all meeting participants. The EHDl Annual Meeting opposes the disruption of any meeting sessions or events that results in the inability for dialogue to take place. The EHDl Annual Meeting reserves the right to withdraw the name badge, and therefore deny access, to participants who do not adhere to these Principles of Participation.

ACCESSIBILITY GUIDELINES FOR EHDl MEETING PARTICIPANTS AND SESSION PRESENTERS

The EHDl Meeting Planning Committee developed guidelines and checklists to maximize access for all participants in the EHDl Annual Meeting. The full guidelines are available on the EHDl Meeting website:

<http://ehdimeeting.org/includes/AccessibilityGuidelines2018.pdf>

Thank you all for helping make the valuable information and dialogue at the EHDl Meeting accessible to all participants.

ACCESSIBILITY SERVICES

If you noted through the EHDl Meeting registration process or made arrangements with the EHDl Meeting organizers in advance for services, please check in with staff at the EHDl Meeting registration desk when you arrive at the EHDl Meeting to confirm arrangements. Please see the EHDl Meeting staff if you encounter any problems during the EHDl Meeting or need further assistance.

If you have not arranged for services in advance, the EHDl meeting staff and organizers will do their best to accommodate requests onsite.

All continuing education forms, including instructions and requirements for CEU submissions, can be found at the EHDl Annual Meeting Registration Desk.

ALL Continuing Education forms MUST be submitted no later than March 30, 2018 or participants will be responsible for submitting to CEU organizations on their own. Submit forms at the registration desk OR by email to mandy.mcclellan@usu.edu no later than March 30, 2018.



AG Bell Academy for Listening and Spoken Language

At the time this book was printed, the overall Meeting was pending approval for CE credits for the pre-Meeting Instructional Sessions and for the Meeting plenary and breakout sessions by the AG Bell Academy for Listening and Spoken Language. A list of approved sessions will be available at the Meeting.

Information regarding Instructional Sessions and Meeting Sessions that have been approved for CE credits by the AG Bell Academy for Listening and Spoken Language is available at the EHDl Meeting registration desk. You will find instructions and required paperwork at the registration desk as well. Completed forms should be submitted to the registration desk prior to leaving the Meeting.

Illinois Early Intervention Training Program

At the time this book was printed, approval was pending to offer continuing education credit from the Illinois Early Intervention Training program for the 2018 EHDl Annual Meeting. If approved, sessions approved for credit will be found at <https://eitp.education.illinois.edu>. It is the responsibility of the individual to provide proof of attendance or completion of this activity to provider connections.

National Commission for Health Education Credentialing, Inc. (NCHEC)

At the time this book was printed, approval was pending for NCHAM to be a designated provider and to offer CE credit from the National Commission for Health Education Credentialing, Inc. If approved, this program will be designated to offer Certified Health Education Specialists (CHES) and the list of approved sessions and required paperwork will be available at the EHDl Annual Meeting Registration Desk. Completed forms should be submitted to the registration desk prior to leaving the Meeting.

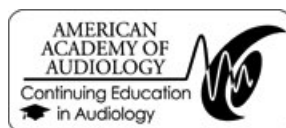

American Academy of Audiology

At the time this book was printed, approval was pending for NCHAM to offer continuing education from the American Academy of Audiology. If approved, the program will be worth a maximum of 2.5 CEUs (this includes up to 14 hours of Pre-Meeting Instructional Sessions.) Instructions and the required paperwork will be available at the registration desk. Completed forms should be submitted to the registration desk prior to leaving the Meeting.

Academy approval of this continuing education activity does not imply endorsement of course content, specific products, or clinical procedures.

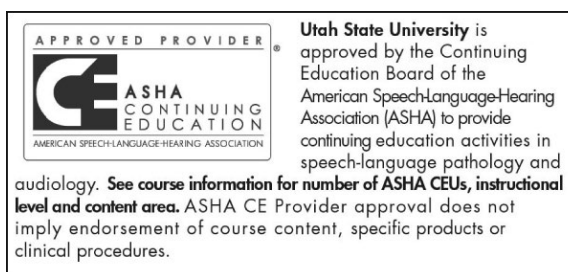

American Speech-Language-Hearing Association

If approved, this course is offered for up to 2.6 ASHA CEUs (Intermediate level, Professional area). The National Center on Hearing Assessment and Management has submitted an application to the American Speech-Language-Hearing Association to offer CEUs for the 2018 EHDl Annual Meeting. The program may be worth a maximum of 2.6 CEUs, if approved. Instructions and the required paperwork (ASHA participant form and instructions) are available at the registration desk. Completed forms should be submitted to the registration desk prior to leaving the Meeting.

Approval of this continuing education activity does not imply endorsement of course content, specific products, or clinical procedures.

DINING

DOWNTOWN DENVER RESTAURANTS

Home to award-winning chefs and restaurateurs, Denver has emerged as one of the top dining locations in the country. Denver's local culinary scene is thriving, offering everything from farm-to-table bistros to classic steakhouses to historic Denver restaurants.

To find the best restaurants in Denver, visit www.denver.org/restaurants/denver-dining/

AT THE HOTEL

Altitude

Experience upscale all-day dining in an inviting atmosphere at Altitude. Altitude serves up local favorites, traditional comfort foods, and many unique creations.

Perks Coffee & More

Discover why Perks is a favorite for hotel guests. Great food in a casual setting awaits you at Perks Coffee & More open 24 hrs.

Peaks Lounge

Enjoy breathtaking views of downtown and surrounding Rocky Mountains atop the Hyatt Regency. Voted one of Denver's Best Scenic Sixteen. Enjoy unique Colorado cocktails and appetizer creations with a view at Peaks Lounge.

Strata Bar

Located on the main level. Relax in this open cocktail area bordered by a four-story glass wall.

NEAR THE HOTEL

Sage Restaurant Group

Stoic & Genuine

Wayward Restaurant

Morton's Steakhouse

The Cheesecake Factory

Tag Restaurant

Zoe's Kitchen

Panzano

1515 Restaurant

EDGE Restaurant & Bar

THINGS TO DO

POPULAR SIGHTS AND DENVER ACTIVITIES

Take a break from your busy routine and discover all the fun things to do in Denver when you stay at Hyatt Regency Denver. The striking, state-of-the-art hotel is perfectly situated near 16th Street Mall giving you easy access to exciting local attractions, such as the Denver Theater District. From intriguing shops and outstanding restaurants to sporting arenas and even top winter ski resorts, you can enjoy it all just minutes from this downtown hotel.

Located adjacent to the Colorado Convention Center, Hyatt Regency Denver is a contemporary hotel where families can relax, play and explore the exciting city of Denver, CO. Enjoy a refreshing swim in the heated indoor pool, workout in our Hyatt StayFit™ Gym, or schedule a rejuvenating treatment at Spa Universaire. When you're ready to explore the city, hop on a Denver B-Cycle located just outside the front doors of the hotel. Speak with the hotel Concierge about arranging a bike rental.

NEAR THE HOTEL

State Capitol

Denver Mint

Denver Botanic Gardens

Denver Pavilions

Larimer Square

TO INSPIRE EVERY DEAF STUDENT TO THINK, TO LEARN, TO ACHIEVE, TO CARE.



Rocky Mountain Deaf School 1997-2017
Celebrating 20 years!

10300 W Nassau Ave, Denver CO 80235
720-961-9200 VP 303-984-5749 V
info@rmds.co www.rmds.co



RMDS is a free public charter school, pre-school through 12th grade, in Jefferson county, just outside Denver, Colorado, and the only bilingual American Sign Language/English charter school in the state. RMDS aims for excellence in research-based academic programs, creating opportunities for students to socialize with and create lasting friendships, and views each student as a success story.

Paid Advertisement. Information in this advertisement does not reflect any type of endorsement by the EHDI Meeting Organizers or Planning Committee.

LIFE'S TODAYS AND TOMORROWS YOU DEFINITELY WANT TO HEAR IT

MED-EL

SYNCHRONY COCHLEAR IMPLANT SYSTEM

Your tomorrow is just as important as your today.

MED-EL is the leader in providing soft, flexible electrode arrays to ensure maximum protection of the delicate structures in the cochlea. Preserving these structures give users the best chance to benefit from future technologies.

Whether you are 1 or 101, structure preservation is critical in maximizing your hearing potential, today and tomorrow.



SYNCHRONY Cochlear Implant System
with FLEX electrode array

Visit medel.com for more details.

hearLIFE

For information on potential risks and contraindications relating to implantation, please visit www.medel.com/us/isi-cochlear-implant-systems/

Antonia Brancia Maxon Award for EHDI Excellence

The **Antonia Brancia Maxon Award for EHDI Excellence** honors the career achievements of Dr. Antonia Brancia Maxon in promoting effective EHDI programs for all newborns, infants, and young children. Dr. Maxon was a visionary in EHDI programs, beginning with her leadership in the Rhode Island Hearing Assessment Project in the late 1980's. She was one of the first to recognize the feasibility and value of universal newborn hearing screening and was a tireless advocate for connecting screening programs with timely and appropriate diagnosis and early intervention.

Her extensive contributions to creating excellent EHDI programs were abruptly ended by a tragic automobile accident in May of 2007. In memory of her contributions, an **Award for EHDI Excellence** is presented at the EHDI Annual Meeting to honor an individual or group of people who have made a noteworthy accomplishment that contributed to achieving excellence in EHDI programs nationally or in a particular state or region of the country.

Presentation of the 2018 Award

Centennial Ballroom E-H

Monday, March 19

5:30 PM

Antonia Brancia Maxon Award for EHDI Excellence

Past Recipients of the Antonia Brancia Maxon Award for EHDI Excellence

2017 Recipient: Linda Hazard
2016 Recipients: Irene Forsman and Susan Lenihan
2015 Recipient: Elizabeth Seeliger
2014 Recipient: Christine "Christie" Yoshinaga-Itano
2013 Recipient: Janet Farrell
2012 Recipient: Betty R. Vohr
2011 Recipient: Jean L. Johnson
2010 Recipients: Beth Benedict and Al Mehl
2009 Recipients: LeeAnne Seaver and Janet DesGeorges
2008 Recipients: Judith Gravel and Mary Hartnett

Nominees for the 2018 Antonia Brancia Maxon Award for EHDI Excellence

Robert Cicco
Lenore Holte
Judith Marlowe
Jessica Messersmith
Heather Morrow-Almeida
South Dakota EHDI Collaborative
Stephanie Olsen and Karen Putz
Anna Wagner
Yusnita Weirather and Nancy Rushmer

**Thank you to all who submitted
nominations for this year's award.**

More information about the accomplishments of each of the recipients of the Antonia Brancia Maxon Award for EHDI Excellence can be found at <http://ehdiconference.org/Award.cfm>

EHDI Family Leadership Award

2018 is the second year for the EHDI Family Leadership Award. During the last several decades it has become increasingly clear that EHDI only exists to improve the well-being of babies and families. Symbiotically, engaged families are central to the success of EHDI programs and more specifically to the success of children who are deaf or hard of hearing.

This award honors a parent or family member of a child who is deaf or hard of hearing for providing exemplary leadership in their state EHDI system and whose leadership has led to improved outcomes. The recipient was selected by NCHAM's Family Advisory Committee.

Presentation of the 2018 Award

**Centennial Ballroom E-H
Monday, March 19
9:00 AM**

Nominees for the 2018 Family Leadership Award for EHDI Excellence

Rachel Coleman
Christine Griffin
Shelli Janning
Irene Schmalz
Melissa Tumblin

**Thank you to all who submitted nominations
for this year's award.**

More information about the accomplishments of each of the recipients of the Family Leadership Award for EHDI Excellence can be found at <http://ehdiconference.org/Award.cfm>

VISIT US AT
EHDI

Otodynamics
OAE + ABR

Otoport

DP CLINICAL

Exactly What's Needed For Clinical OAEs

Otoport DP Clinical provides high quality **12 frequency DPgrams** with normative range markers from **1 to 8kHz**. Tests are highly configurable. You can pre-configure **two clinical DPOAE modes** which are easily accessible. Select the stimulus level from 6 L1,L2 combination and choose the analysis display as half octave or DPgram.

Add TEOAE to complete your clinical OAE examination. TEOAEs analysis displayed as a **waveform or as 1/2 octave bands, 1-4kHz**. There are two pre-configurable TEOAE clinical modes.

The Otoport DP Clinical pediatric screening mode is **fast and highly effective** with newborns and children, alerting you to the possibility of both conductive and cochlear losses. For pediatric screening the Otoport DP Clinical **visual distraction displays**, help keep them quiet. One of 3 cartoons will engage the child. The cartoon gradually fills with color if the child is quiet but colors fade when child is noisy.

SATISFIES CPT code 92588 and 92587 (92558 and 92586 with options)

EXPANDABLE

OAE + ABR

Add automated ABR screening with the easy to fit ABR sleeve



1-800-659-7776
E: info@otodynamics.com
www.otodynamics.com

ANNIVERSARY EDITION

Otodynamics

OPENING PLENARY

MONDAY, March 19, 2018

8:00 AM–9:00 AM

CENTENNIAL BALLROOM E-H

Crucial Conversations: The Benefits of Exploring Differing Opinions

It is not uncommon for people to shy away from or avoid situations where individuals have differing opinions. Vital Smarts research demonstrates that when there are opposing opinions, high stakes and strong emotions, we often are not at our best. Yet, there are benefits to holding dialogue and learning from the other's perspective. When we get our motives right and demonstrate respect to those with differing opinions, some of our greatest ideas and synergy occur. Learn to identify crucial moments so that you can enter into dialogue which can strengthen relationships and produce better results.



Beth Wolfson

CEO – Leadership Consulting Services

Beth Wolfson is the founder and CEO of Beth Wolfson - Leadership Consulting Services. She operates on her philosophy that one person can truly make a difference in any organization or group. She combines 20 years of executive level management with over 16 years of consultative and training experience. In her role to organizations as consultant, trainer and facilitator, she has worked with most industry sectors and with people ranging from individual contributors to the CEO. Beth helps clients with projects including team building, conflict resolution, organizational development, executive consulting, and communication strategies by bringing a rare ability to understand the unique challenges, beliefs and un-discussable issues underlying organizations' problems. By creating personal connections, her clients are better able to take risks and release old mental models and beliefs to achieve surprising results in record time. While clients gain tangible results and useful skills, it is often the personal shifts that occur that allow people to strengthen their interpersonal relationships that are the most valuable in going forward. New insights and ways of thinking about themselves, their teams, and their organizations form the basis for long lasting change that creates the true value of Beth's work with them.

Clients often say that Beth's insight and ability to bring difficult issues into focus motivate participants to action. By helping her clients reframe their issues, innovative solutions and opportunities are often recognized which lead to breakthrough results. Participants consistently notice and relate to Beth's high positive energy and single-minded focus on helping them. Beth holds a BS from the Medical University of South Carolina and a MA in Applied Communications from Denver University.



PLENARY II

MONDAY, March 19, 2018

4:25 PM–5:30 PM

CENTENNIAL BALLROOM E-H

Broadening Perspectives: A Collaboration Between Traditionally Divisive Ideological Camps on Deaf Education

In Fall 2016, the Moog Center, a private oral school in St. Louis, Missouri that teaches children with hearing loss to talk, joined with DEAF, Inc., a non-profit organization that focuses on advocacy and communication access for the deaf community, to pilot a program to broaden perspectives for children with hearing loss and their families.

DEAF, Inc. and The Moog Center recognize that choices regarding methodology of deaf education can be divisive and there is a need to collaborate with parents and families along with their children to understand that this does not have to be the case. Through the creation of safe spaces for dialogue, parents have provided feedback indicating that there is a strong interest in understanding the possible contribution of sign language and the deaf community as a part of social identity development in the deaf child's future as a tool to develop language and social identity along with the importance of Spoken English. Together, these organizations began offering an after-school program for the school students and their parents in an effort to break down barriers and misconceptions, including sign language, and expose children and their parents to the broader deaf community. The collaborative program in which the Moog Center and DEAF, Inc. have engaged has shown promise in bridging often divisive perspectives into the shared pursuit of providing early intervention and language choices for the deaf child and their families.



Betsy Moog-Brooks

Executive Director - Moog Center for Deaf Education



Thomas Horejes

Associate Provost - Gallaudet University

Betsy Moog Brooks is the Executive Director of the Moog Center for Deaf Education, a non-profit private school that teaches children with hearing loss to talk. She recently earned her Doctor of Education in Instructional Leadership with an emphasis in Andragogy, the study of adult learners. She received her Master's degree in Speech

and Hearing from Washington University and is certified in Deaf Education, Behavior Disorders, Learning Disabilities, Early Childhood Education and is a Listening and Spoken Language Specialist. She has been in the field of early intervention for more than 30 years and continues to provide direct child service and parent support to families with children birth to three.

Dr. Thomas Horejes received his PhD in Justice Studies at Arizona State University and is currently Gallaudet University's Associate Provost of Student Success & Academic Quality. Prior to his position at Gallaudet, he was former Executive Director of DEAF, Inc.—based in St. Louis—that provides advocacy and interpreting services to the deaf/hard of hearing community. He has numerous publications, including a book entitled, *Social Constructions of Deafness: Examining Deaf Languacultures in Education*. He is also former professor of sociology at Gallaudet University.



PLENARY III

TUESDAY, March 20, 2018

8:00 AM–9:00 AM

CENTENNIAL BALLROOM E-H

Shine a Light: Fostering Development Across Domains

Early identification of hearing status, early exposure to accessible language, early amplification (where relevant), and implementation of early intervention have benefitted countless children who are deaf or hard of hearing. Building on the shoulders of the giants in our field, research has been undertaken and policies have been introduced that truly promote improved outcomes. With the appropriate early supports, young children with reduced hearing and their families are, in many ways, thriving. This presentation will celebrate some of the successes that we, together, have achieved. It will also serve as a reminder that, despite the enormous progress that has been made, areas of vulnerability remain for many deaf and hard-of-hearing children. By shedding some light on the various domains of development, this presentation will aim to broaden the scope of how we think about and support deaf and hard-of-hearing children. Much of the work in the field has focused intently on language development (whether signed or spoken); yet when we illuminate the needs of the whole child, we bring to light other areas of development that also critically important. Families often possess a flicker of hope regarding the possibilities for their child. Yet, further involving caregivers in the journey to learn more about their child's development, can fan their flames of passion to help realize the child's optimal potential.



Amy Szarkowski

*Deaf and Hard of Hearing Program,
Dept. of Otolaryngology &
Communication Enhancement, at
Boston Children's Hospital*

Amy Szarkowski, PhD, is a psychologist who specializes in working with children with reduced hearing and their families. She works

in the Deaf and Hard of Hearing Program at Boston Children's Hospital (BCH), where she offers guidance to families, provides individualized counseling to deaf and hard of hearing children and adolescence, and serves as a member of an interdisciplinary team that performs comprehensive assessments. Dr. Szarkowski is on the Core Faculty for LEND (Leadership Education in Neurodevelopmental and related Disabilities), at BCH, sponsored through the Institute for Community Inclusion (ICI)/UMass Boston. Through LEND, she teaches and advises future leaders in health care about the needs of children with reduced hearing and children with disabilities interacting with medical systems. Dr. Szarkowski holds an academic appointment in the Department of Psychiatry at Harvard Medical School. She has also had the pleasure of teaching as an adjunct faculty member in the Deaf and Hard of Hearing Infants, Toddlers, and Families: Collaboration and Leadership Program at Gallaudet University.



Congenital cytomegalovirus, or CMV, is the leading, non-genetic cause of hearing loss in children.

CMV is common, serious, and preventable.



**Learn more and
donate today.**

Booth 24, Exhibit Hall

www.NationalCMV.org

Paid Advertisement. Information in this advertisement does not reflect any type of endorsement by the EHDI Meeting Organizers or Planning Committee.

Powerful Newborn Hearing Solutions



corti™

- DP/TEOAE Screening
- Infant, Children, & Adult Testing
- 4 Button Navigation
- GSI Suite™ Software
- Screening & Diagnostic Options



novus™

NEW

- AABR/DP/TEOAE Screening
- Perfect for Newborn Hearing Testing
- Touch Screen Navigation
- HearSIM™ Software
- Binaural Testing

The GSI Corti™ and Novus™ continue the tradition of excellence in audiometry and the Grason-Stadler legacy of fast, efficient, and familiar navigation.

These portable, hand-held instruments have the ability to screen or test a baby in just seconds. Each device has a straight forward and logical interface that is easy to use, requiring minimal staff training time.

Learn more about both solutions at GSI booth #22.

Setting The Clinical Standard

800-700-2282 | www.grason-stadler.com



BabyBeats™

early intervention resource



BabyBeats™ from Advanced Bionics and Phonak, now available on the App Store and Google Play

Guide families to learn how to use music with their baby following identification of a hearing loss.

Use the **BABYBEATS EARLY INTERVENTION RESOURCE APP** to guide parent and baby through musical activities to stimulate:

- **bonding**
- **brain development**
- **early communication and listening skills**
- **early literacy skills**

Ready to help parents BOND, PLAY and LEARN?

Download the BabyBeats App today!

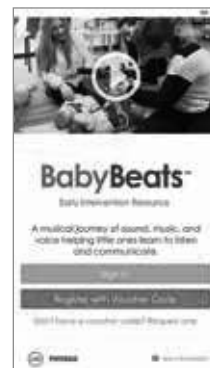

PHONAK

Apple®, iPad®, iTunes® and iPhone® are registered trademarks of Apple Inc. Android™ and Google Play™ are registered trademarks of Google Inc.

3-02076
©2018 Advanced Bionics AG and affiliates. All rights reserved.

EXHIBIT & POSTER LOCATIONS

This year's Poster Hall is sponsored by Oticon Pediatrics.

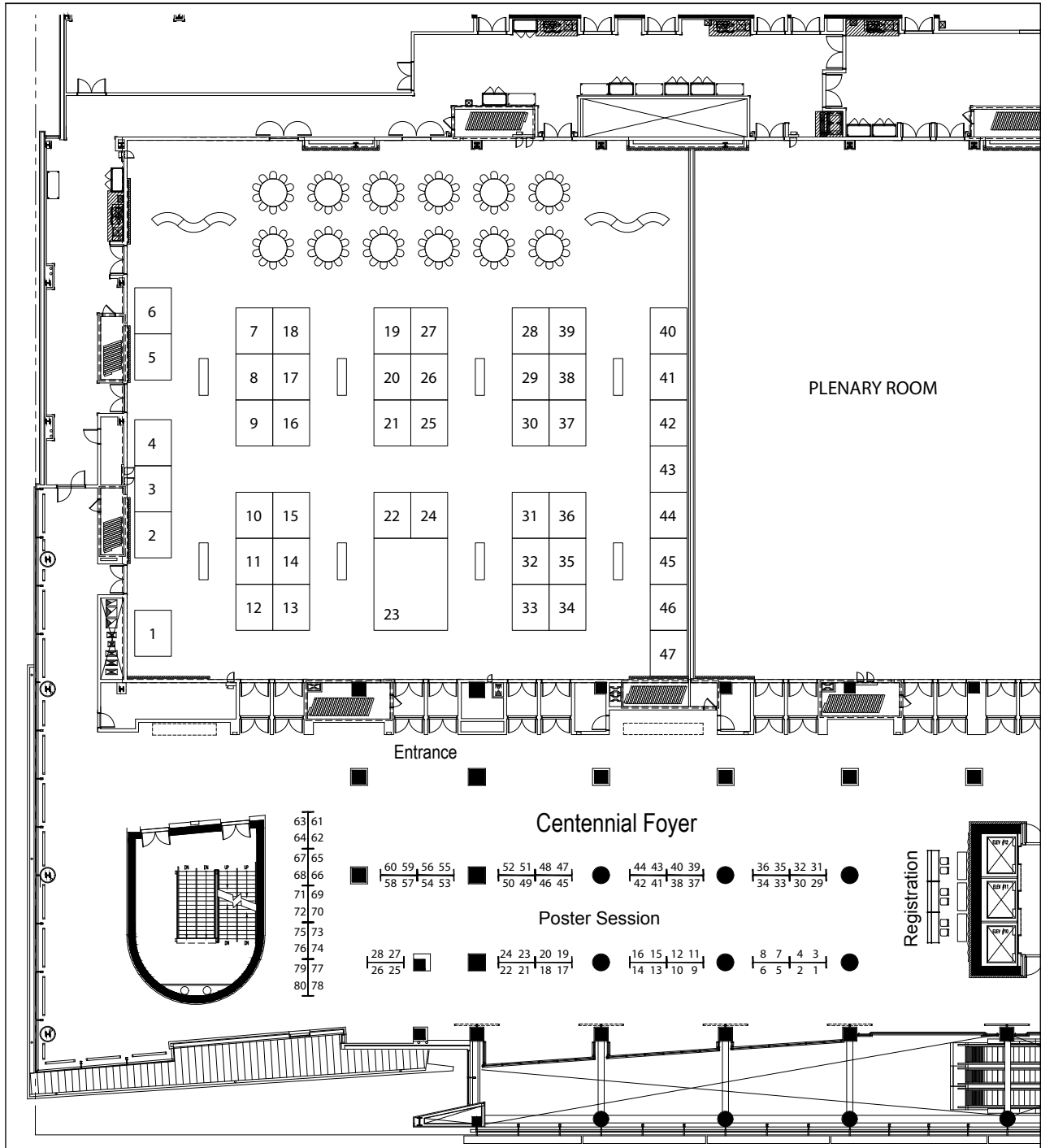

EXHIBITS

EXHIBIT HALL - CENTENNIAL BALLROOM A-D

The 2018 EHDI Meeting Planning Committee would like to express their appreciation to all of the following exhibitors for supporting the EHDI Meeting. Exhibits will be open:

Sunday, March 18
6:00 PM–8:00 PM

Monday, March 19
7:15 AM–5:30 PM

Tuesday, March 20
7:15 AM–11:00 AM

EXHIBIT BOOTHS

1	2 Ears 2 Learn
2	SComm
3	The Holley Institute
4	Medtronic
5	Beginnings for Parents of Children who are Deaf or Hard of Hearing, Inc.
7	Otodynamics LTD
8	Laurent Clerc National Deaf Education Center
9	Boy's Town National Research Hospital
10	CID-Central Institute for the Deaf
11	ASHA
12	Intelligent Hearing Systems
13	The CARE Project
14	MAICO Diagnostics
15	MAICO Diagnostics
16	Gallaudet University
17	SignOn
18	Rocky Mountain ADA Center/Meeting the Challenge, N/A Inc.
19	Family Trac
20	Listen Foundation, Inc.
21	American Society for Deaf Children
22	Grason-Stadler
23	*MED-EL Corporation
24	*National CMV Foundation

25	*Vivosonic Inc.
26	Dallas Hearing Foundation
27	*Pediatrix
28	OZ Systems
29	Phonak, LLC
30	*Advanced Bionics
31	*Oticon Pediatrics
32	Natus Medical Inc
33	*Otometrics/Audiology Systems
34	Cochlear Americas
35	GN Resound
36	Audioscan
37	Alexander Graham Bell Association for the Deaf and Hard of Hearing
38	CDC
39	Rocky Mountain Deaf School
40	LENA Foundation
41	Hands & Voices
42	Hands & Voices
43	Oticon Medical
44	National Cued Speech Association
45	NCHAM
46	Ear Community
47	Colorado School for the Deaf and the Blind

***2018 Sponsor**

EXHIBITORS

2 Ears 2 Learn

Booth 1
100 E Idaho Street #318
Boise, ID 83712
208-949-6975
info@2ears2learn.org
www.2ears2learn.org

Advanced Bionics

Booth 30
28515 Westinghouse Place
Valencia, CA 91355
866-844-4327
hear@advancedbionics.com
www.advancedbionics.com

Alexander Graham Bell Association for the Deaf and Hard of Hearing

Booth 37
3417 Volta Place, NW
Washington, DC 20007
202-204-4683
gyates@agbell.org
www.agbell.org

American Society for Deaf Children

Booth 21
800 Florida Avenue, NE, #2047
Washington, DC 20002-3695
800-942-2732
asdc@deafchildren.org
www.deafchildren.org

ASHA

Booth 11
2200 Research Blvd
Rockville, MD 20850
301-296-5791
aoyler@asha.org
www.asha.org

Audioscan

Booth 36
20 Ludwig Street
Dorchester, ON, Canada N0L 1G4
519-268-3313
800-265-2093
info@audioscan.com
www.audioscan.com

Beginnings for Parents of Children who are Deaf or Hard of Hearing, Inc.

Booth 5
156-A Wind Chime Cart
Raleigh, North Carolina 27615
919-909-5489
raleigh@ncbegin.org

Boys Town National Research Hospital

Booth 9
425 North 30th Street
Omaha, NE 68131
402-452-5032
healthinfo@boystown.org
www.boystownhospital.org

Centers for Disease Control and Prevention

Booth 38
4770 Buford Highway
MS E-88
Atlanta, GA 30341
404-498-3035
EHDI@cdc.gov
www.cdc.gov/ncbddd/
hearingloss/index.html

CID—Central Institute for the Deaf

Booth 10
825 South Taylor Avenue
Saint Louis, MO 63110
314-977-0132
cid@cid.edu
www.cid.edu

Cochlear Americas

Booth 34
13059 E Peakview Avenue
Centennial, CO 80111
1-877-883-3101
CamClinicService@cochlear.com
www.cochlear.com/us

Colorado School for the Deaf and the Blind

Booth 47
33 N Institute Street
Colorado Springs, CO 80903
719-578-2100
csdboutreach@csdb.org
www.csdb.org

Dallas Hearing Foundation

Booth 26
7777 Forest Lane
CA94 PMB 143
Dallas, TX 75230
972-424-7711
jennifer.clark@dallashearingfoundation.org
www.dallashearingfoundation.org

Ear Community

Booth 46
280 E 1st Avenue, Unit 704
Broomfield, CO 80038
303-646-7126
earcommunity@gmail.com
www.earcommunity.org

FamilyTrac

Booth 19
12713 Waterman Drive
Raleigh, NC 27614
919-412-1923
chuck.scheier@familytrac.com
www.familytrac.com

Gallaudet University

Booth 16
800 Florida Avenue NE
Washington, DC 20002
202-250-2038
beth.benedict@gallaudet.edu
www.gallaudet.edu

GN Resound

Booth 35
8001 E Bloomington Freeway
Bloomington, MN 55420
612-400-2843
rdixon@gnresound.com
www.resound.com

Grason-Stadler

Booth 22
10395 West 70th Street
Eden Prairie, MN 55344
800-700-2282
info@grason-stadler.com
www.grason-stadler.com

Hands & Voices

Booths 41, 42
PO Box 3093
Boulder, CO 80307
303-921-9631
jeannene@handsandvoices.org
www.handsandvoices.org

Intelligent Hearing Systems

Booth 12
6860 SW 81st Street
Miami, FL 33143
1-800-447-9783
sales@ihsys.com
www.ihsys.com

Laurent Clerc National Deaf Education Center

Booth: 8
Gallaudet University
800 Florida Avenue NE
Washington, DC 20002
202-651-5933
Stacy.Abrams@Gallaudet.edu
www.gallaudet.edu/clerc-center.html

LENA Foundation

Booth: 40
5525 Central Avenue, Suite 100
Boulder, CO 80301
1-303-545-9696
info@lena.org
www.lena.org

Listen Foundation, Inc.

Booth: 20
6950 E Bellevue Avenue
Greenwood Village, CO 80111
303-781-9440
info@listenfoundation.org
www.listenfoundation.org

MAICO Diagnostics

Booths 14, 15
10393 West 70th Street
Eden Prairie, MN 55344
1-888-941-4201
info@maico-diagnostics.com
www.maico-diagnostics.com/us

MED-EL Corporation

Booth 23
2645 Meridian Parkway
Durham, NC 27713
1-888-633-3524
implants.us@medel.com
www.medel.com

Medtronic

Booth 4
6743 Southpoint Drive North
Jacksonville, FL 32216
800-874-5797
rs.sophonoinformation@medtronic.com
www.sophono.com

National CMV Foundation

Booth 24
PO Box 18322
Tampa, FL 33679
813-207-0017
advocacy@nationalcmv.org
www.nationalcmv.org



We're all ears (and brainstem response too)

Providing newborn hearing screens using Automated Auditory Brainstem Response Screening technology since 1999

It takes a team! As a hearing screen provider and advocate, we are always listening and appreciate your feedback. We are proud of the relationships we have built and the collaboration with parents, primary care providers, state EHDI programs, audiologists, ENTs, early intervention teams and other stakeholders. For over 20 years we have provided high quality screening services understanding that the screen is only the beginning. But we don't rest on our laurels. We are committed to continuous improvement of screen practices to ensure all infants with congenital hearing loss are identified at birth and provided collaborative and coordinated follow-up for timely intervention.

 **Visit us at booth #27** and pick up a copy of our poster presentation:

Auditory Neuropathy Spectrum Disorder (ANSD) identified in Well-Baby nursery (WBN) infants who referred newborn hearing screening



NEWBORN HEARING SCREENS

PEDIATRIX

an affiliate of **MEDNAX**

National Cued Speech Association

Booth 44
1300 Pennsylvania Avenue NW
Suite 190-713
Washington, DC 20004
800-459-3529
sroffe@cuedspeech.org
www.cuedspeech.org

Natus Medical Incorporated

Booth 32
1501 Industrial Road
San Carlos, CA 94070
650-802-0400
Sales and Support:
+1 800-303-0306
NatusMarCom@natus.com
www.natus.com

NCHAM—National Center for Hearing Assessment & Management

Booth 45
Utah State University
2615 Old Main Hill
Logan, UT 84322-2615
435-797-3013
karl.white@usu.edu
www.infantheating.org

Oticon Medical

Booth 43
580 Howard Avenue
Somerset, NJ 08873
888-277-8014
info@oticonmedicalusa.com
www.oticonmedical.com/us

Oticon Pediatrics

Booth 31
580 Howard Avenue
Somerset, NJ 08873
888-684-7331
M.Doty@oticon.com
www.oticon.com

Otodynamics LTD

Booth 7
30-38 Beaconsfield Road
Hadfield, Herts,
Hadfield, AL108BB
800-659-7776
lee@otodynamics.com
www.otodynamics.com

Otometrics/Audiology Systems

Booth 33
50 Commerce Drive
Suite # 180
Schaumburg, IL 60173
800-289-2150
dadlin@otometrics.com
www.otometrics.com

OZ Systems

Booth 28
2201 E Lamar Blvd
Suite 260
Arlington, TX 76006
888-727-3366
ozhelp@ozsystems.com
www.oz-systems.com

Pediatric

Booth 27
1500 Concord Terrace
2nd Floor
Sunrise, FL 33323
954-650-7469
Laura_hall-koethe@mednax.com
www.mednax.com

Phonak, LLC

Booth 29
4520 Weaver Parkway
Warrenville, IL 60555
800-777-7333
Dawn.Rule@phonak.com
www.phonak.com

Rocky Mountain ADA Center/ Meeting the Challenge, Inc.

Booth 18
3630 Sinton Road, Suite 103
Colorado Springs, CO 80907
800-949-4232
msims@mtc-inc.com
www.RockyMountainADA.org

Rocky Mountain Deaf School

Booth 39
10300 W Nassau Avenue
Denver, CO 80235
720-961-9200
anovotny@rmds.co
www.rmds.co

SComm

Booth 2
6238 Hadley Street
Raytown, Missouri 64133
816-350-7008
lynn@scomm.com
www.sComm.com

SignOn

Booth 17
296 Lothrop
Grosse Pointe Farms, MI 48236
313-539-3246
ashlee@signonconnect.com
www.signonconnect.com

The CARE Project

Booth 13
716 Staley Court
Raleigh, NC 27609
910-233-0994
johnnie@thecareproject.com
www.thecareproject.com

The Holley Institute

Booth 3
1142 Ventura Drive
Brooklyn, MI 49230
313-449-8158
alexa.craig@assension.org
www.holleyfv.org

Vivosonic Inc.

Booth 25
5535 Eglinton Avenue West
Unit 222
Toronto, ON M9C 5K5
Toll Free (USA/Canada):
+1-877-255-7685
info@vivosonic.com
www.vivosonic.com



ReSound GN

Because listening is the key to learning

The ability to focus on speech is essential to learning. The ReSound Multi Mic delivers crystal clear sound up to 80 feet away in clear line of sight, doubles as a table microphone and connects with loop and educational Assistive Listening Device (ALD) systems, like those found in many schools.

Learn more at resound.com/connectivity

GN Making Life Sound Better



FREE ReSound Multi Mic
with your purchase of a
ReSound pediatric hearing aid*

Smart Hearing?

© 2018 GN ReSound A/S. All rights reserved. Apple, the Apple logo, iPhone, iPad and iPod are registered trademarks of Apple Inc. * Patients must be 18 years or younger. Some exclusions may apply.

September 23-25, 2018

Abstract submissions close April 2, 2018

CMV

CONGENITAL CYTOMEGALOVIRUS
PUBLIC HEALTH & POLICY CONFERENCE
BURLINGTON, VERMONT 2018



**STOP
CMV**

Come learn how you can reduce the number of babies born with CMV!

For more information, please visit www.cmv.usu.edu

VERSATILITY

Whether it's a handheld or a desktop, Sentiero devices perfectly suit your hearing screening and diagnostic needs.



The PATH Sentiero devices are configured with either single tests or multiple tests in one small unit. Handheld units offer Otoacoustic Emissions (OAEs) or OAEs and audiometry. Desktop units offer tympanometry, tympanometry with OAE or tympanometry with OAEs and audiometry. Unique features include the patented FMDPOAE™ that maximizes your ability to obtain a response and the ability to test OAEs on both ears simultaneously. These battery operated, compact, and lightweight devices make them easy to transport.

Call 847.534.6948 today and mention PATH1803-EHDI to schedule an in-clinic Sentiero product demo. Live product demo at EHDl Annual Meeting booth #33!

Otometrics/Audiology Systems is the national U.S. distributor of PATH MEDICAL solutions.

855.283.7978
www.audiologysystems.com/screening

PATH1803-EHDI

 **otometrics** | **audiology systems**
a division of natus.

THANK YOU TO OUR SPONSORS

The EHDl Annual Meeting organizers and Planning Committee would like to recognize and thank them for their sponsorship contributions to the 2018 EHDl Annual Meeting.

PLATINUM LEVEL SPONSOR

MED⁹EL

BRONZE LEVEL SPONSORS



SILVER LEVEL SPONSORS



vivosonic

oticon

PEDIATRICS



Advanced Bionics

Chicago²⁰¹⁹



18th Annual Meeting ~ March 3-5, 2019

Hyatt Regency O'Hare ~ Chicago, IL

Hyatt Regency Denver

FLOOR PLAN

Third Level

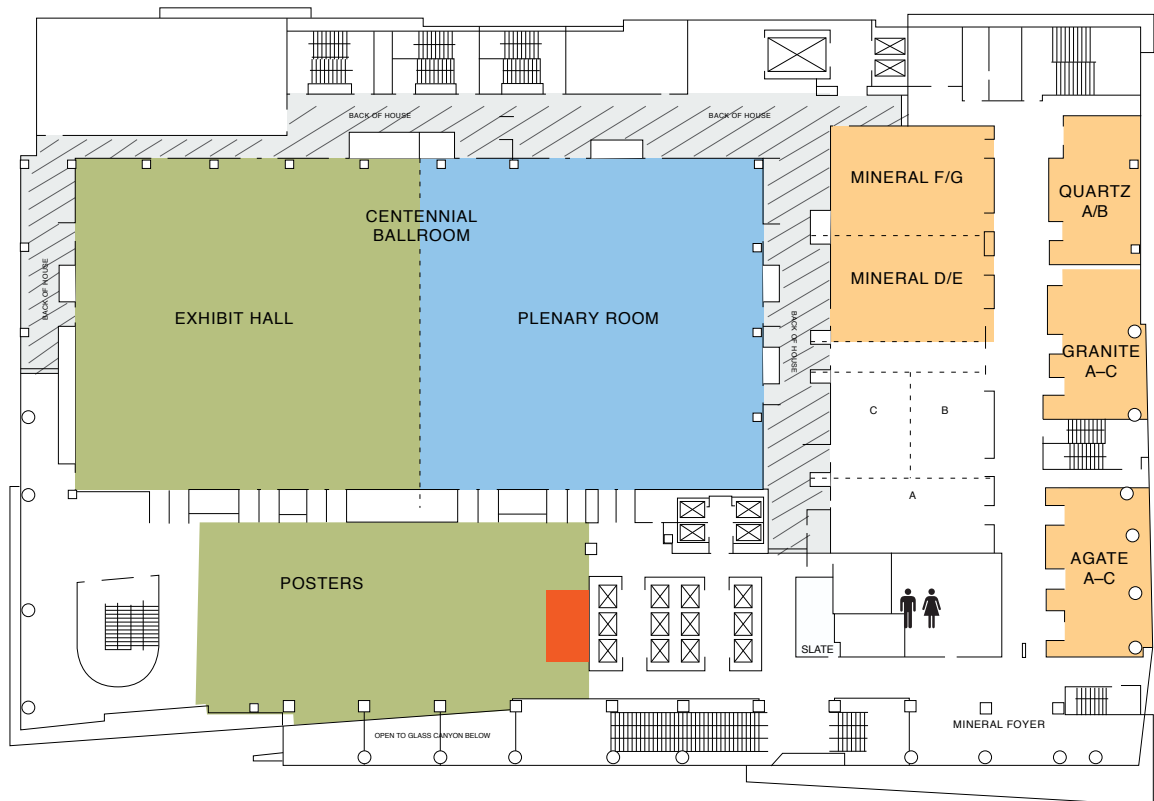

Fourth Level

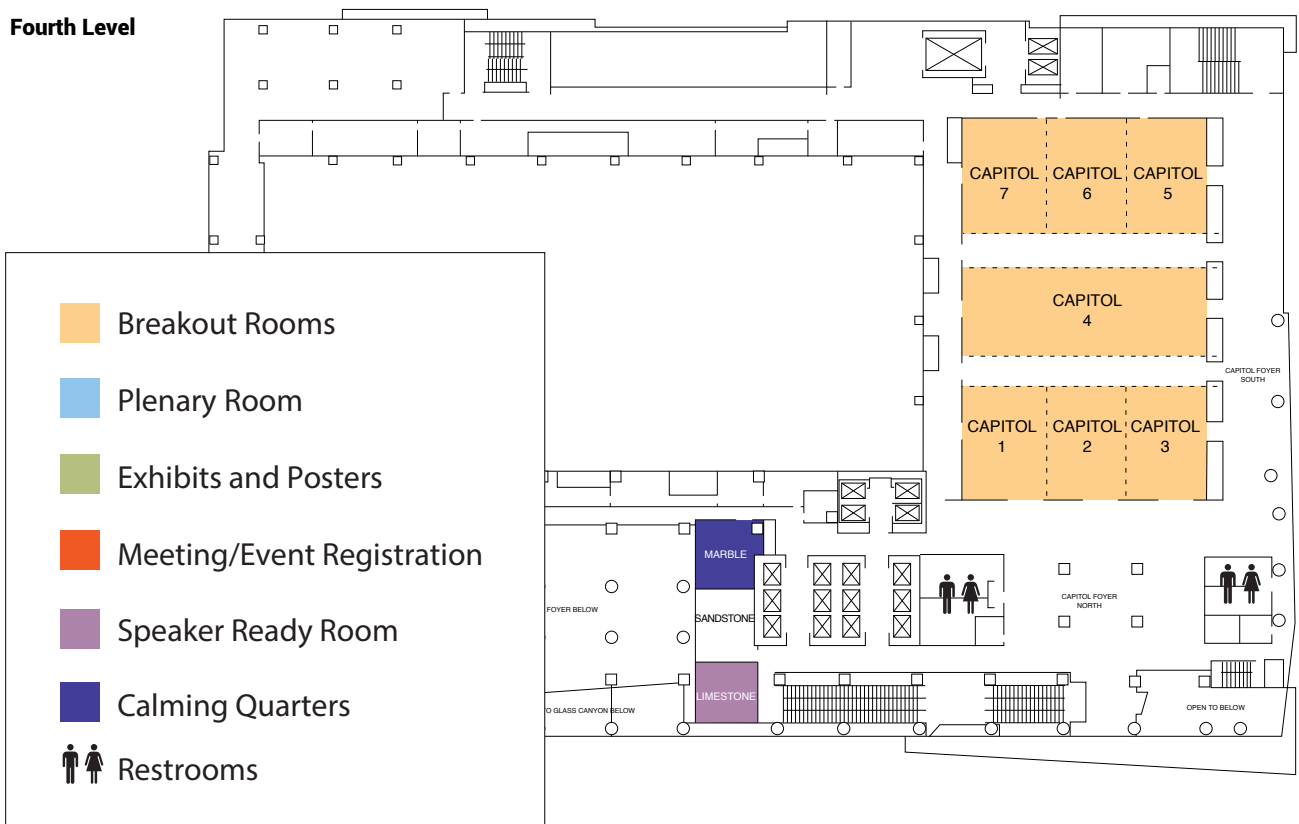

Saturday, March 17, 2018		
8:30 AM - 5:00 PM	Joint Committee on Infant Hearing	Agate A-C
1:00 PM - 4:00 PM	DHSPSHWA Executive Board Meeting	Sandstone
2:00 PM - 5:00 PM	Islands/Outlying Territories Meeting	Mineral F/G
5:00 PM - 6:30 PM	MCHB/HRSA Meet and Greet Reception	Granite A-C

Sunday, March 18, 2018		
7:15 AM - 8:00 PM	Pre-Meeting Registration Open	
8:00 AM - 3:00 PM	EHDI Coordinator Meeting	Capitol 4
8:00 AM - 5:00 PM	Presenter Ready Room Open	Limestone
8:00 AM - 4:00 PM	Instructional Sessions: 12 Total	
2:00 PM - 5:00 PM	Workshop for LEND Audiology Trainees: Intersectionality of Culture and Diversity	Mineral F/G
12:00 PM - 6:00 PM	Exhibit Set-up Poster Set-up	Exhibit Hall / Centennial Ballroom
3:00 PM - 8:00 PM	AAP Regional Network Liaison Workshop	Agate A-C
3:30 PM - 5:30 PM	Annual DSHPSHWA Meeting	Capitol 4
4:30 PM - 6:00 PM	EHDI 101	Centennial Ballroom E-H
5:15 PM - 6:30 PM	EHDI Student Kickoff	Mineral D/E
6:00 PM - 8:00 PM	Exhibits Open Reception	Exhibit Hall / Centennial Ballroom
7:00 PM - 9:00 PM	Parent Gathering	Centennial Ballroom E-H
7:00 PM - 9:00 PM	Storytelling	Marble

Monday, March 19, 2018		
6:45 AM - 8:00 AM	Continental Breakfast	Exhibit Hall/ Centennial Ballroom
7:00 AM - 7:50 AM	Food for Thought: Student-Professional Networking Session	Mineral D/E
7:00 AM - 3:30 PM	Registration Open	
7:15 AM - 5:30 PM	Exhibits Open	Exhibit Hall/ Centennial Ballroom
	Presenter Ready Room	Limestone
8:00 AM - 9:00 AM	Plenary I: Beth Wolfson <i>'Crucial Conversations'</i>	Centennial Ballroom E-H
9:00 AM - 9:15 AM	Presentation of the EHDI Family Leadership Award	Centennial Ballroom E-H
9:15 AM - 9:25 AM	Overview of State Stakeholders' Meetings	Centennial Ballroom E-H
9:30 AM - 11:00 AM	State Stakeholders' Meetings	Various Locations
11:00 AM - 11:15 AM	Break	
11:15 AM - 12:15 PM	Topical Session 1	
12:00 PM - 2:00 PM	HRSA/MCHB Office Hours (No appointment needed)	Cottonwood Suite
12:15 PM - 2:00 PM	Lunch (On Your Own)	
12:15 PM - 1:45 PM	Hands & Voices FL3 Language & Literacy Advisory Board Meeting	Quartz A/B
12:35 PM - 2:00 PM	Parent Lunch Meeting	Capitol 4
12:45 PM - 2:00 PM	Poster Session	Exhibit Hall / Centennial Ballroom
2:00 PM - 2:15 PM	Break	

Monday, March 19, 2018 (Continued)		
2:00 PM - 4:00 PM	HRSA/MCHB Office Hours (No appointment needed)	Cottonwood Suite
2:15 PM - 3:15 PM	Topical Session 2	
3:15 PM - 3:35 PM	Refreshment Break	Exhibit Hall / Centennial Ballroom
3:35 PM - 4:05 PM	Topical Session 3	
4:05 PM - 4:25 PM	Break	
4:25 PM - 5:30 PM	Plenary II: Betsy Moog-Brooks and Thomas Horejcs <i>'Broadening Perspectives: A Collaboration Between Traditionally Divisive Ideological Camps on Deaf Education'</i>	Centennial Ballroom E-H
5:30 PM - 5:45 PM	Presentation of the Antonia Brancia Maxon Award for EHDI Excellence	Centennial Ballroom E-H
5:45 PM - 6:45 PM	Deaf Professionals Panel Discussion—Who are We?	Mineral F/G
6:00 PM - 7:00 PM	Deaf and Hard of Hearing Adult Involvement Learning Community	Quartz A/B
7:00 PM - 8:30 PM	AAP Participant Working Session	Agate A-C

Tuesday, March 20, 2018		
6:45 AM - 8:00 AM	Continental Breakfast	Exhibit Hall/ Centennial Ballroom
7:00 AM - 7:50 AM	Food for Thought: Student-Professional Networking Session	Mineral D/E
7:00 AM - 12:00 PM	Registration Open	
7:15 AM - 11:00 AM	Exhibits Open	Exhibit Hall / Centennial Ballroom
7:15 AM - 3:15 PM	Presenter Ready Room	Limestone
8:00 AM - 9:00 AM	Plenary III: Amy Szarkowski <i>'Shine a Light: Fostering Development Across Domains'</i>	Centennial Ballroom E-H
9:00 AM - 9:20 AM	Presentation of Poster and Website Awards	Centennial Ballroom E-H
9:20 AM - 9:40 AM	Refreshment Break	Exhibit Hall / Centennial Ballroom
9:40 AM - 10:40 AM	Topical Session 4	
10:40 AM - 11:00 AM	Break	
11:00 AM - 12:00 PM	Topical Session 5	
12:00 PM - 1:45 PM	Lunch (On Your Own)	
12:00 PM - 2:00 PM	HRSA/MCHB Office Hours (No appointment needed)	Cottonwood Suite
1:45 PM - 2:45 PM	Topical Session 6	
2:00 PM - 4:00 PM	HRSA/MCHB Office Hours (No appointment needed)	Cottonwood Suite
2:45 PM - 3:00 PM	Break	
3:00 PM - 3:30 PM	Topical Session 7	
3:30 PM - 3:45 PM	Refreshment Break	Exhibit Hall / Centennial Ballroom
3:45 PM - 4:45 PM	Topical Session 8	

Wednesday, March 21, 2018		
7:30 AM - 2:00 PM	Field Trip - Colorado School for the Deaf and the Blind	
9:00 AM - 1:00 PM	Field Trip - Rocky Mountain Deaf School	
8:00 AM - 3:00 PM	Instructional Sessions: 2 Total	